



# YETI SB5+ PROTECTIVE DECAL APPLICATION

# SB5+ DECAL PROTECTOR KIT PLACEMENT INSTRUCTIONS

This guide is intended to give you the approximate placements for your decal protector kit. Some modification may be necessary when applying to assembled bikes. If you are not starting with a new bike you will want to thoroughly clean your bike before beginning this process.

Work in a clean dry place with space. Minimize your contact with the adhesive surfaces. Clean your hands thoroughly and lay out your decals.

\*Dirty hands result in discoloration that will be permanent and visible.

Adding a little heat will help you in applying the decals to complex shapes and curves. Have your hair dryer or heat gun at the ready. Be sure you use low heat and do not hold the heat on the decal or the frame too long. Overheating will result in discoloring and deforming of the decal.

**\*CAUTION:** Excessive heat can damage your decals and potentially damage your carbon frame. Any damage to caused by improper installation of the protector decals will not be covered by warranty.

## WHAT YOU WILL NEED TO GET STARTED:

- \_\_\_\_ LINT FREE RAG
- \_\_\_\_ RUBBING ALCOHOL
- \_\_\_\_ HAIR DRYER/HEAT GUN
- \_\_\_\_ CLEAN BIKE
- \_\_\_\_ CLEAN HANDS
- \_\_\_\_ MEASURING DEVICE

**\*NOTE:** Feel free to cut out any custom shapes you might want using the remaining decal scraps. Get creative!

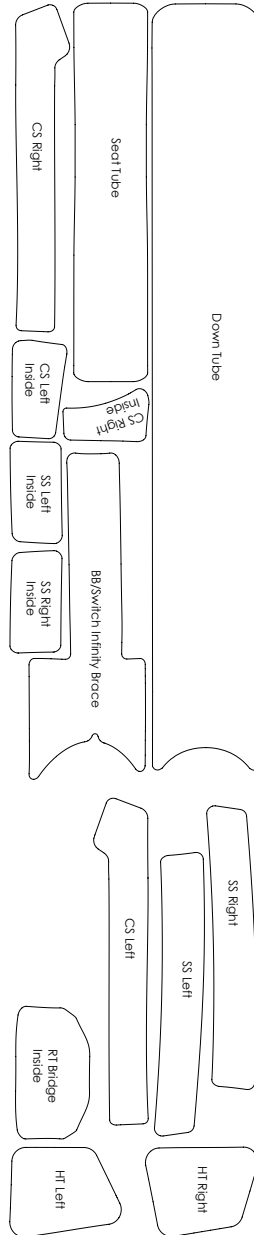

## DOWN TUBE PROTECTOR:

Place the lower end of the down tube protector decal approximately 2mm above the rubber protector. Starting at the bottom, stick the center of the decal onto the down tube all the way to upper end. Grab your heat gun and lightly heat the decal in the area you are working. Work from the centerline out to the edges sticking the decal down.

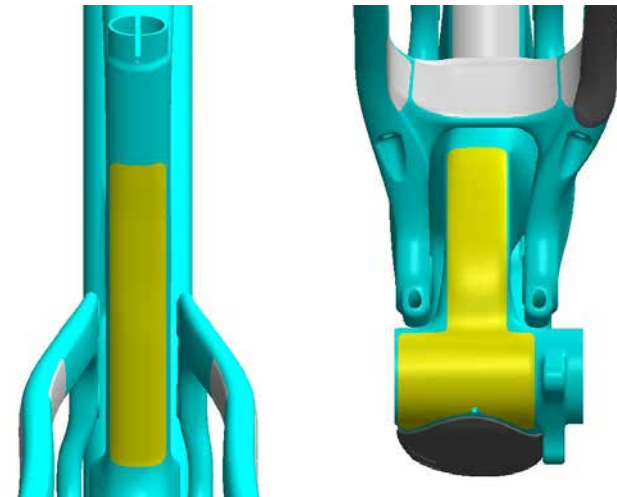

## SEAT TUBE AND INFINITY LINK BRACE AND BB:

Place the seat tube protector decal on the back of the seat tube, starting ~50mm from the top of the tube. Stick the center of the decal to the tube and work outward towards the edges. Use heat if needed, but on this round tube you should be able to easily stick the decal without it. Place the Switch Infinity Link brace/BB protector decal on the flat surface on the back of the brace and BB as seen on the right. Start at the BB and work your way up using the BB vent hole as a starting point. It will match up with the notch in the decal. Use heat to conform the decal to the edges and curves.

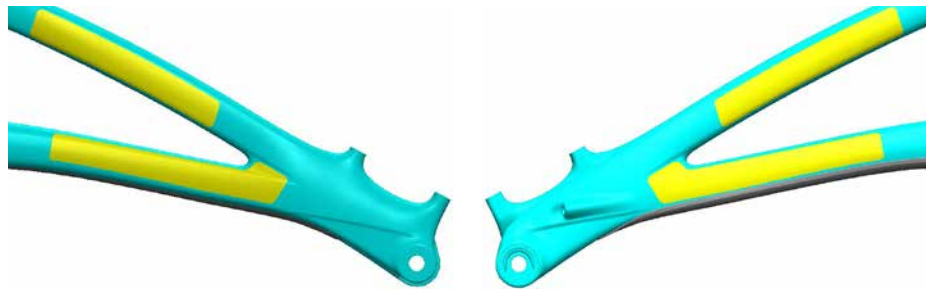

### CHAIN AND SEAT STAY HEEL STRIKE GUARDS:

Drive-side placement shown on the left, non-drive side on the right. Place as shown, use heat as needed to help conform to curves and edges.

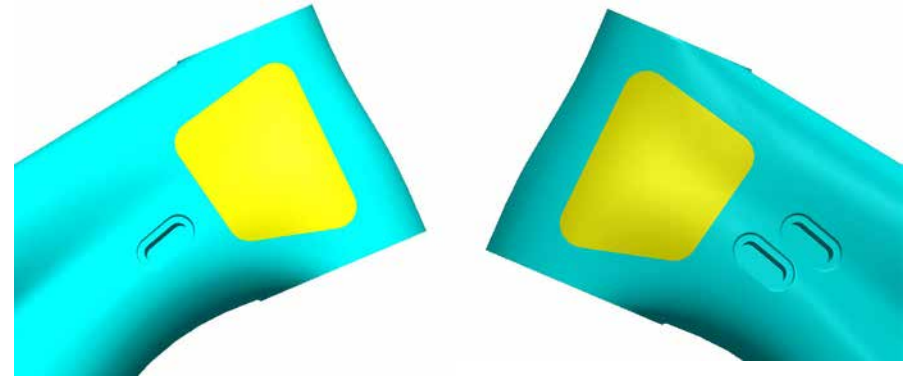

### HEAD TUBE CABLE RUB PROTECTOR:

Place one protector on either side of the head tube in front of the cable housing ports. The drive, or right side, should be placed ~10mm in front of the dropper post housing port. The non drive, or left side, should be placed ~9mm in front of the lower housing port.

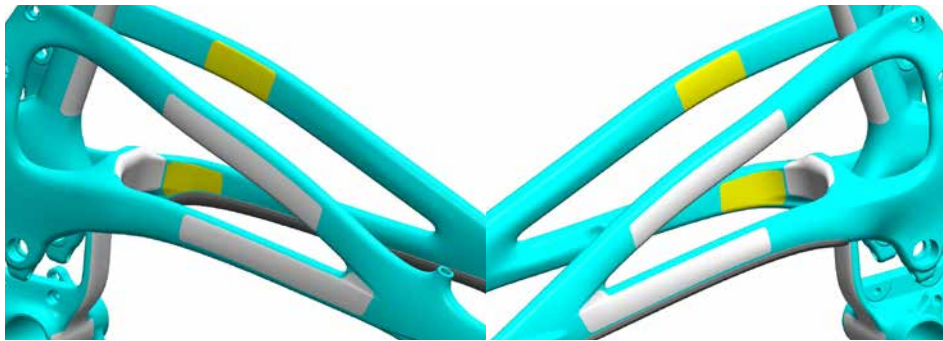

### CHAIN AND SEAT STAY TIRE RUB GUARDS:

Marked as SS and ST, R and L, inside. Place the decals as shown. The Chain stay (CS) and seat stay (SS) inside decals should be fitted where potential tire contact would occur, as shown above.

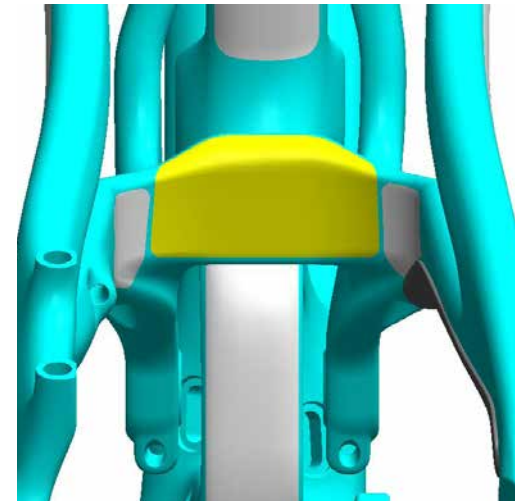

### REAR TRIANGLE BRIDGE PROTECTOR:

Place this protector decal on the back of the chainstay bridge on your swingarm. The shape of the decal dictates its placement pretty well. You may want to use a little heat on this one to get it to conform to the complex curves of the bridge too.

**\*CAUTION:** Too much heat can damage the decal and even the frame. Use heat carefully and sparingly.

**NOW THAT YOUR BIKE IS CLEAN AND PROTECTED, GO OUT AND GET IT DIRTY!**

If you have any questions related to your protector decals or any other part of your bike please feel free to drop us a line any time. We are always happy to help!

[yeticycles.com/support](http://yeticycles.com/support)  
[service@yeticycles.com](mailto:service@yeticycles.com)

**YETI CYCLES**

621 Corporate Circle, Unit B  
Golden, CO 80401  
(p) 303-278-6909

**BUSINESS HOURS**

Monday-Friday  
8AM-11:30AM, 1:00PM-5:30PM  
(Mountain Time)