



BIKE FRAME PROTECTION KIT

SB120 / SB135 / SB140 / SB160 / SB165

PLACEMENT INSTRUCTIONS

BIKE FRAME PROTECTION KIT

PLACEMENT INSTRUCTIONS

WHAT YOU'LL NEED TO GET STARTED

- Lint free rag
- Spray bottle with soap
- Hair dryer / heat gun
- Clean bike
- Clean hands
- Measuring device

INSTRUCTIONS

1. Clean bike thoroughly with mild soap and water prior to decal application. It is best if you can apply decals on a new frame.
 2. Wash hands before application or wear a pair of nitrile/latex gloves to keep any dirt from sticking to the decal.
 3. Get a spray bottle full of water. Add a drop or two of soap to help the decals slide around if needed.
 4. Working with one decal at a time, spray the appropriate area of the frame and adhesive-side of the decal.
 5. Place decal in the locations provided below, re-placing or sliding decal as needed.
 6. Once the decal is in the right spot, use the provided squeegee to start flattening the decal onto the frame. Start in the middle, working along the middle length. Gradually squeeze out the water toward the edges, working thoroughly and patiently to remove ALL water under the decal.
 7. Use a clean cloth or towel to help lay the decal flat and wipe off excess water. At this point, some edges of the decals might not be perfectly flat on the frame.
 8. Using a heat gun or hairdryer on low setting, apply heat to the decal edges for 2-3 seconds at a time. Using a clean rag or squeegee, work on any edges or bumps to lay them flush to the frame. Re-apply heat and repeat as necessary.
 9. When it's time to remove or replace your protective decals, use a heat gun to warm up adhesive and pull back decal slowly. Do not remove without warming up decal adhesive first. Clean off any residual adhesive with mild soap and water.
- NOTE:**
Feel free to cut out any custom shapes you might want using the remaining decal scraps. Get creative!

DECALS

BOTTOM BRACKET



SWITCH BRACE



DOWNTUBE + XL/XXL



TOP TUBE



SEATTUBE + XL/XXL



REAR TRIANGLE BRIDGE



CHAINSTAY - INNER LEFT/RIGHT



RIGHT SEATSTAY/CHAINSTAY - OUTER



LEFT SEATSTAY/CHAINSTAY - OUTER



INNER SEATSTAY



ROTOR GUARD



REAR DERAILLEUR



SHUTTLE GUARD



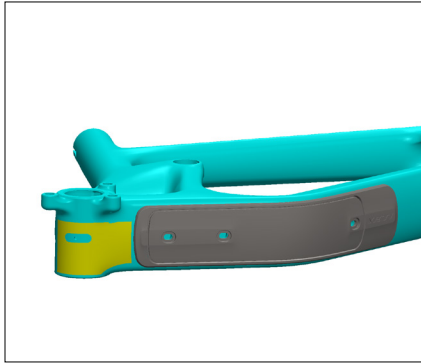

BOTTOM BRACKET

Assure the drain hole in the bottom of frame is centered in the decal slot, and the side of the decal is parallel with the side edge of the frame. Place the decal behind the rubber protector.

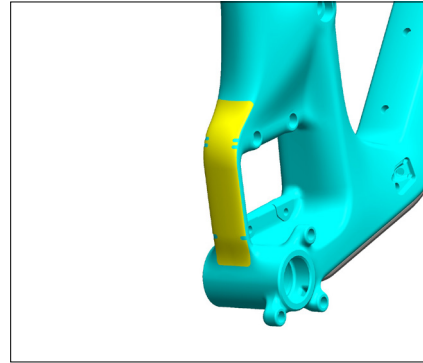

SWITCH BRACE

Center decal on switch brace, placing relief cutouts on the bends in the brace.

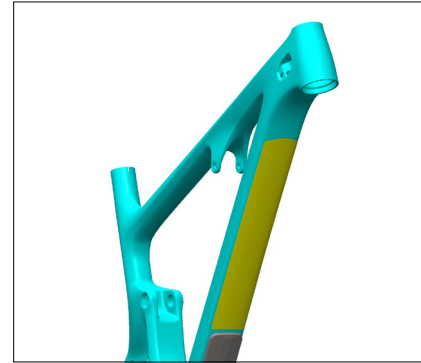

DOWNTUBE

Center decal on downtube, placing it above rubber protector. For XL and XXL frames, place downtube extension decal above downtube decal.

If running a shuttle guard, place shuttle guard decal between rubber protectors instead of downtube decal.

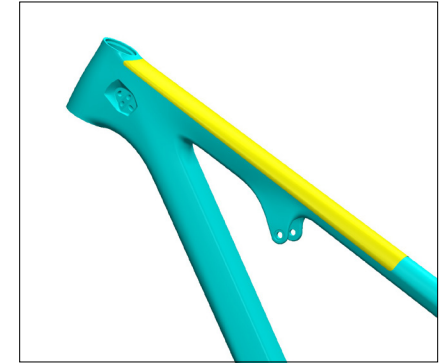

TOP TUBE

Center decal on top tube. Decal will wrap around top tube corners. Place decal behind headset.

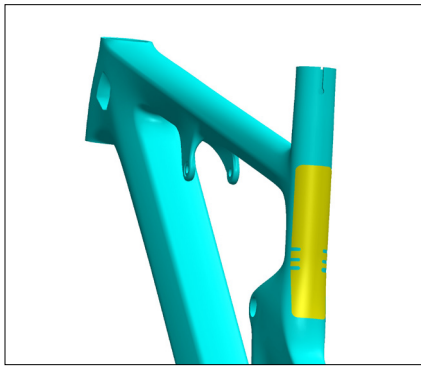

SEAT TUBE

Center decal on back of seat tube, and place relief cuts on transition from switch brace to straight section of seat tube.

For larger frames, use seat Tube extension decal above seat tube decal.

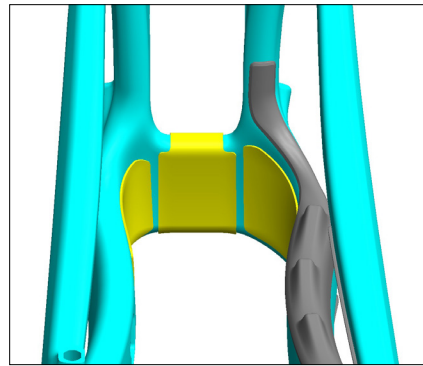

REAR TRIANGLE BRIDGE

Center bridge decal on rear triangle bridge, with decal 'shoulders' touching lining up with the start of curvature at the top of the bridge. Wrap the decal around the top and bottoms of the bridge.

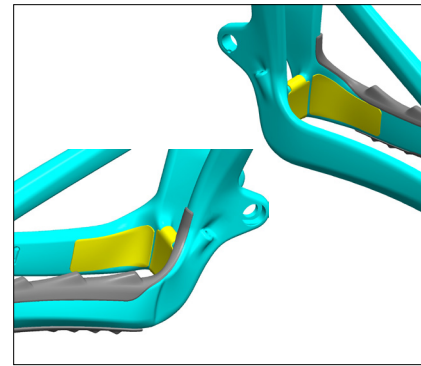

INNER CHAINSTAYS

Line up inner edge with bridge decal. Center decal between rubber guards on right side. Center decal on chainstay on left side.

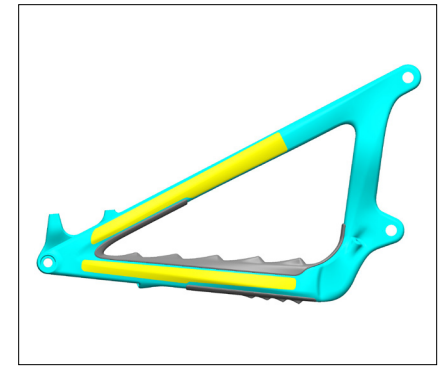

RIGHT SEATSTAY/CHAINSTAY OUTER

Center decals between rubber protectors and line up cutouts with rubber guards.

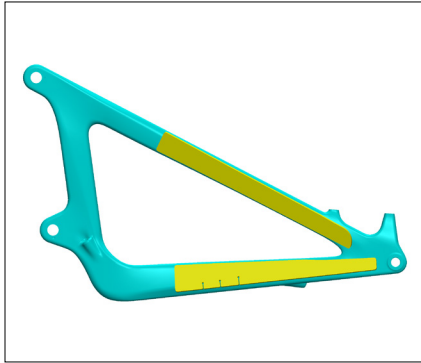

LEFT SEATSTAY/CHAINSTAY OUTER

Center decals on chainstay and seatstays.
Assure chainstay decal is behind any graphics.

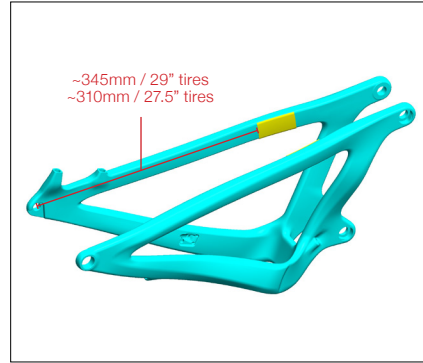

INNER SEATSTAY

Center decals on seatstays, with rear edges
of decals ~345mm from axle for 29" tires
and ~310mm from axle for 27.5" tires.

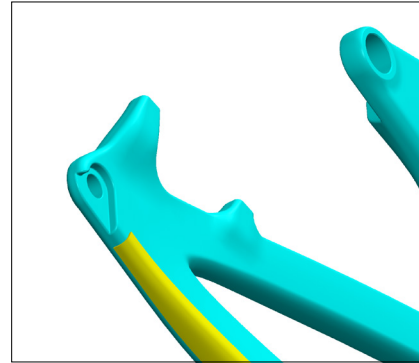

ROTOR GUARD

Place on inside of chainstay, just ahead
of dropout.

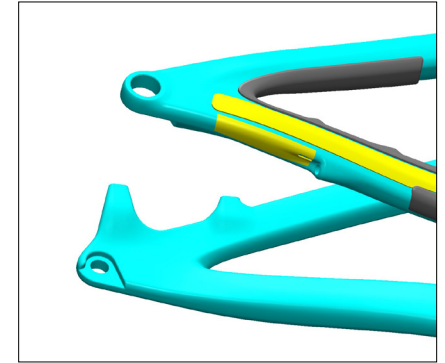

REAR DERAILLEUR

Line up decal with bottom of outer chainstay
decal. Front of decal should be just behind
derailleur port, with relief cut running along
channel in carbon.