

SB100 SWITCH INFINITY PRELOAD ADJUSTMENT

Note: perform this procedure only if your SB100's Switch Infinity starts to develop play between the rails and bushings. It is possible over time for the bushings to break in and need preload adjustment as part of regular maintenance.

01

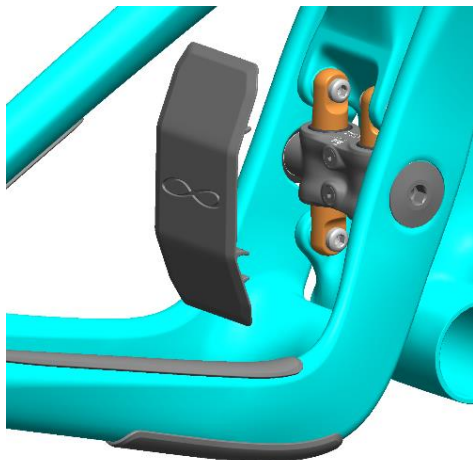

Pull the Switch Infinity Fender from the frame, unclipping it from the Switch Infinity bolt heads. Gently clean the Switch Infinity Link with a rag and mild detergent or alcohol

02

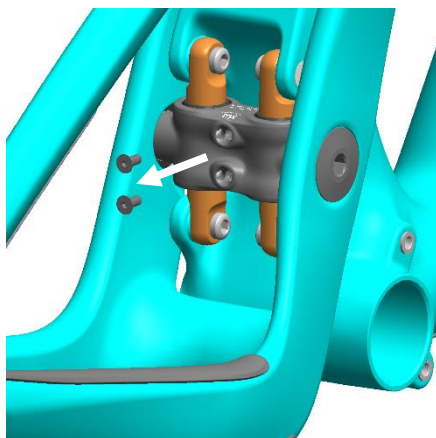

Using a 2.5mm Allen key, remove the Preload Access Screws from the Switch Infinity Link.

03

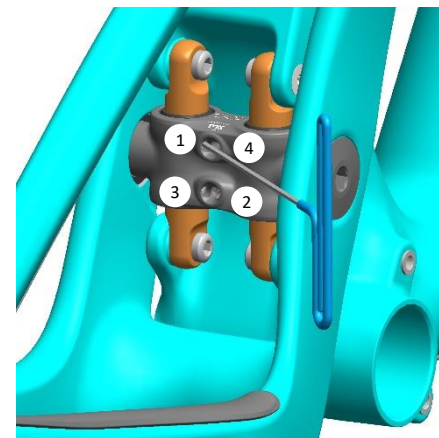

With a 2mm Allen key, back-off the four preload set-screws completely. Gently tighten each screw until it contacts the shaft bushings. Alternating between each shaft, tighten each set screw an additional 1/8 turn to preload the bushing.

04

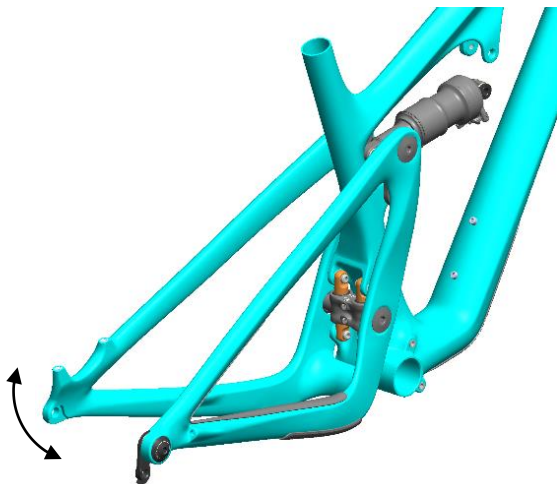

We recommend removing the front shock mount and cycling the suspension to ensure smooth movement. Protect your frame from any shock strikes. If there is any excessive friction within the system, decrease the bushing preload slightly.

05

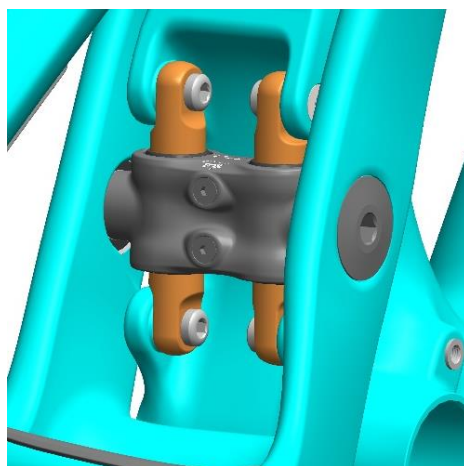

Apply a small drop of Blue Loctite to the Preload Access Screws. Re-install and torque to 3 Nm.

06



Clip the Fender back onto the frame. Service is now complete.