



YETI ASR PROTECTIVE DECAL APPLICATION

ASR DECAL PROTECTOR KIT PLACEMENT INSTRUCTIONS

This guide is intended to give you the approximate placements for your decal protector kit. Some modification may be necessary when applying to assembled bikes. If you are not starting with a new bike you will want to thoroughly clean your bike before beginning this process.

Work in a clean dry place with space. Minimize your contact with the adhesive surfaces. Clean your hands thoroughly and lay out your decals.

*Dirty hands result in discoloration that will be permanent and visible.

Adding a little heat will help you in applying the decals to complex shapes and curves. Have your hair dryer or heat gun at the ready. Be sure you use low heat and do not hold the heat on the decal or the frame too long. Overheating will result in discoloring and deforming of the decal.

***CAUTION:** Excessive heat can damage your decals and potentially damage your carbon frame. Any damage to caused by improper installation of the protector decals will not be covered by warranty.

WHAT YOU WILL NEED TO GET STARTED:

- _____ LINT FREE RAG
- _____ RUBBING ALCOHOL
- _____ HAIR DRYER/HEAT GUN
- _____ CLEAN BIKE
- _____ CLEAN HANDS
- _____ MEASURING DEVICE

***NOTE:** Feel free to cut out any custom shapes you might want using the remaining decal scraps. Get creative!

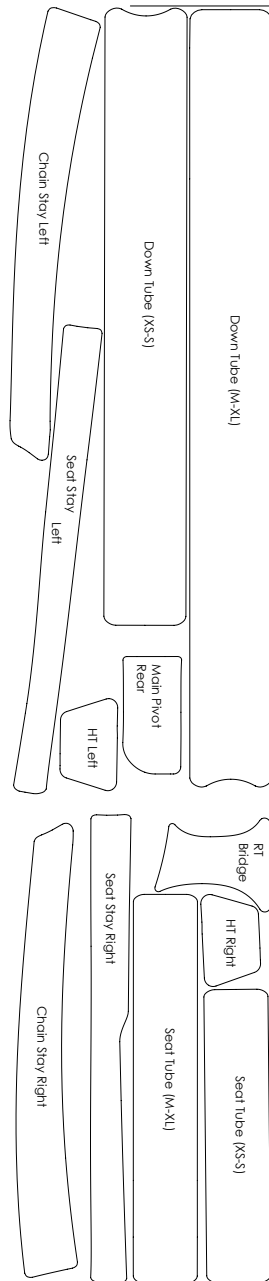

DOWN TUBE PROTECTOR:

Place the lower end of the down tube protector decal approximately 2mm above the rubber protector. Starting at the bottom, stick the center of the decal onto the down tube all the way to upper end. Grab your heat gun and lightly heat the decal in the area you are working. Work from the centerline out to the edges sticking the decal down. ***NOTE:** There are two DT protector sizes. Use the correct one for your frame size! Short for XS and SM, Long for MD-XL.

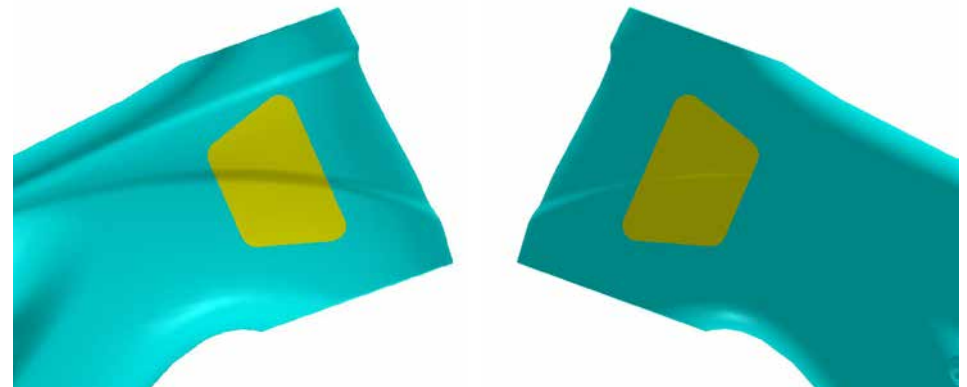

HEAD TUBE CABLE RUB PROTECTOR:

Place one protector on either side of the head tube to prevent cable rub.

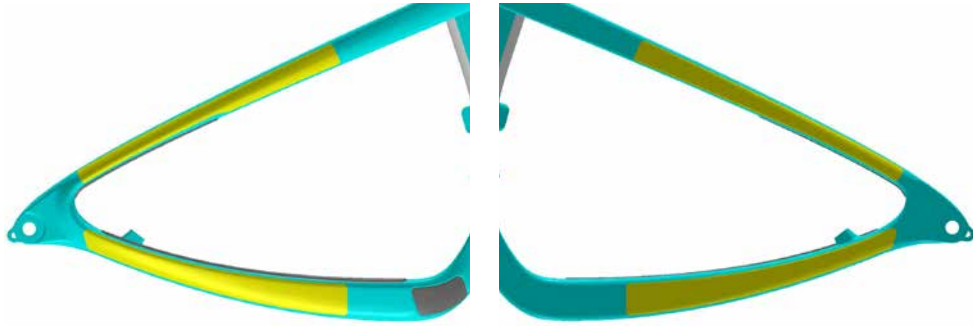

CHAIN AND SEAT STAY HEEL STRIKE GUARDS:

Drive-side placement shown on the left, non-drive side on the right. Place as shown, use heat as needed to help conform to curves and edges.



BOTTOM BRACKET PROTECTOR:

Place this protector decal on the bottom of the bottom bracket as shown above. The gap between the curved edge of the decal should be 2-3mm's from the rubber protector on the down tube. Make sure that the decal does not cover the bottom bracket drain hole.

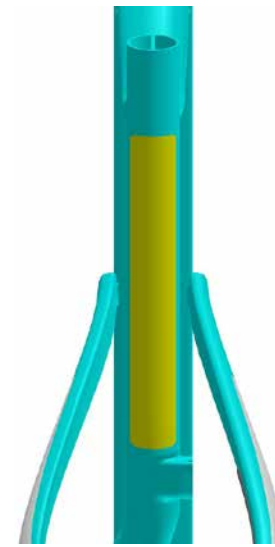

SEAT TUBE:

Place the seat tube protector decal on the back of the seat tube, starting ~50mm from the top of the tube. Stick the center of the decal to the tube and work outward towards the edges. Use heat if needed, but on this round tube you should be able to easily stick the decal without it. ***NOTE:** There are two ST protector sizes. Use the correct one for your frame size! Short for XS and SM, Long for MD-XL.

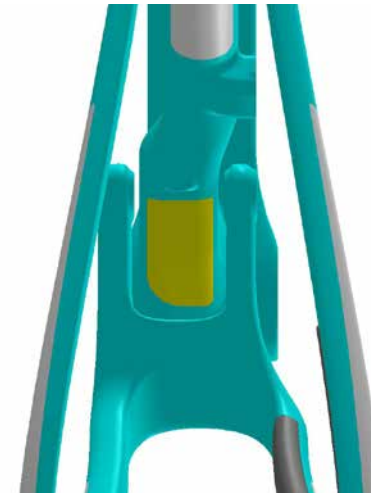

LOWER SEAT TUBE:

Place this protector decal below the internal seat post routing port.

NOW THAT YOUR BIKE IS CLEAN AND PROTECTED, GO OUT AND GET IT DIRTY!

If you have any questions related to your protector decals or any other part of your bike please feel free to drop us a line any time. We are always happy to help!

yeticycles.com/support
service@yeticycles.com

YETI CYCLES

621 Corporate Circle, Unit B
Golden, CO 80401
(p) 303-278-6909

BUSINESS HOURS

Monday-Friday
8AM-11:30AM, 1:00PM-5:30PM
(Mountain Time)